



Eaton's Wiring Devices
Protection devices

Eaton's next generation of Protection devices

Slim. Sleek. Simple.

EATON

Powering Business Worldwide

Slim GFCI, AFCI, AF/GF receptacles & blank face devices

The Eaton difference...



Clean

Minimal markings on the face coupled with black shutters provide a clean, aesthetic appeal, to better blend with décor in today's modern buildings and homes.



Intuitive

Modern features include wider TEST/RESET buttons and LED indicator lights which provide quick identification of a trip or end-of-life event.



Slim

Redesigned to feature a Slim 1.03-inch depth profile which allows installers more room to make connections within the electrical box.



Backed by a legacy of safety

For more than 130 years, Arrow Hart products have been relied on for industry-leading performance in today's toughest electrical projects. Let us prove our passion for protection.



Standard and Tamper Resistant GFCI Receptacles

GFCI provides protection for indoor applications.

GF15 & GF20, TRGF15 & TRGF20 [pg. 4-5](#)



Tamper & Weather Resistant GFCI Receptacles

For use in exterior applications where additional protection against the elements is needed.

TWRGF15 & TWRGF20 [pg. 6](#)



Hospital Grade GFCI Receptacles

Provides GFCI protection for healthcare applications.

TRGF15 & TRGF20 [pg. 7](#)



Controlled GFCI Receptacles

For use within an energy management protocol which requires dedicated circuits to power down.

TRGFC15 & TRGFC20 [pg. 8](#)



AFCI Receptacles

Arc Fault protection against potential electrical arcs which can lead to a fire.

TRAF15 & TRAF20 [pg. 9](#)



AF/GF Receptacles

Combining both Arc Fault and Ground Fault within a single device which provides dual purpose protection.

TRAG15 & TRAG20 [pg. 10](#)



Blank Face Devices

Provides circuit protection in areas where an receptacle isn't needed, but protection is desired.

GFD20 [pg. 11](#)

Slim protection device features & benefits

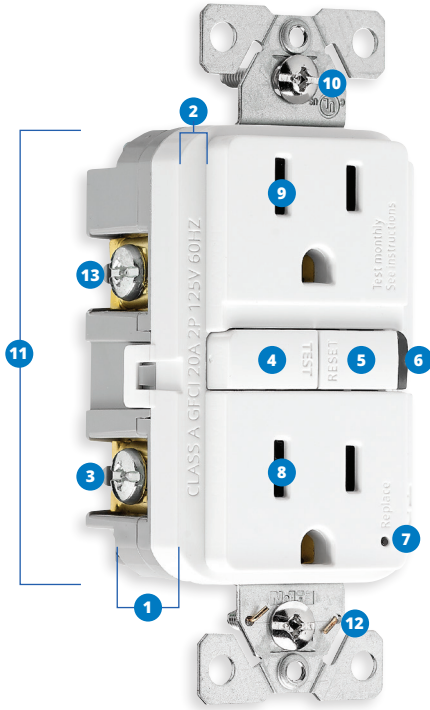

- Slim 1.03-inch depth profile** provides quick and easy installation by allowing more room in the electrical box for wiring, ideal for retrofit as well as two-gang applications.
- Devices **sit more flush** with the wallplate for a pleasing aesthetic.
- External backwire clamp** allows visual confirmation of secure wire termination, increasing safety while saving installation time.
- Wider TEST/RESET buttons** make it easier to test and reset. Device can be reset even while a plug is inserted.
- Minimal top housing markings** are debossed and neutrally positioned for easy reading no matter the installation orientation.
- Industry-first!** Larger reset indicator light on the RESET button allows for quick identification of a trip incident, and intuitively orients the end user to push the RESET button, reducing contractor callbacks, saving time and money.
- End of life indicator light flashes red** and is located next to the embossed word "Replace," making it easy to identify when the device has reached its "end of life" and needs to be replaced.
- Tamper resistant shutter system** allows for easy plug insertion, while preventing children from inserting objects (hairpins, keys), protecting them from electric shock, meeting NEC code 406.12. *(Excludes blank face devices)*
- Tamper resistant shutters** are black to disappear from view, adding to the clean, modern look. *(Excludes blank face devices)*
- Captive screws** allow easier installation.
- Robust thermoplastic construction** provides unmatched durability and high-impact resistance.
- Grounding staple** ensure ground integrity.
- Line side terminals** are backed out for fast installation. All terminals are staked to prevent screws from backing all the way out.

Keeping up with code

The 2023 edition of the National Electrical Code brings some noteworthy changes in regard to GFCI protection.

2023 NEC 406.12 Tamper Resistant Receptacles. All 15- and 20-ampere, 125- and 250-volt nonlocking-type receptacles in the following locations shall be listed tamper resistant receptacles*:

RESIDENTIAL

Required in all dwelling units, boathouses, mobile homes and manufactured homes, including attached and detached garages, accessory buildings, and common areas.

COMMERCIAL

Required in guest rooms and guest suites of hotels, motels, and their common areas; child care facilities, including preschools and education facilities; in clinics, medical and dental offices, and outpatient facilities; dormitory facilities, residential care/assisted living facilities, rehabilitation facilities, and group homes.

NEW IN NEC 2023

Required for agricultural buildings accessible to the general public, such as pumpkin patches, petting farms, christmas tree farms, and similar venues.

*Please refer to latest NEC for full list of locations requiring tamper resistance

How the tamper resistant system works:

Tamper Resistant (TR) receptacles feature a built-in UL listed **safety shutter system** that prevents the insertion of foreign objects into the receptacle openings. The safety shutters will only open when a two-bladed plug presses simultaneously against the two shutters.

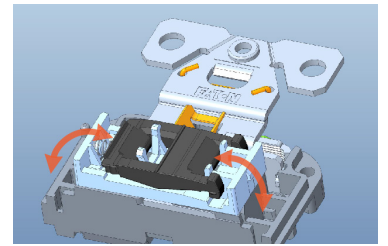

Shutters restrict access in closed position.

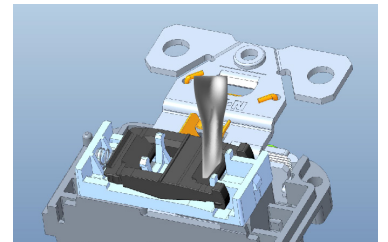

Insertion of object in any one side will not open shutters.

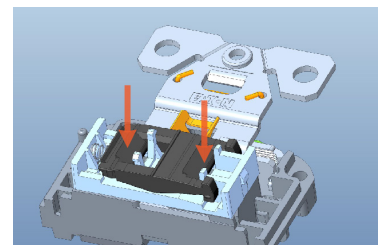

Insertion of two-bladed plug or grounding plug will open shutters.



Standard GFCI receptacle

FEATURES

- Slim design for easy installation, leaving more room for wires in the box
- Automatically self-tests periodically to ensure GFCI protection
- GFCIs incorporate lock-out functionality to protect against mis-wired line-load connections and GFCI circuitry damage
- Intuitive LED status indicators for trip and end of life states
- Meets and exceeds 10 kA short circuit testing and Underwriters Laboratories (UL) UL943 safety standards
- Automatic grounding system eliminates need for bonding jumper in grounded metal enclosure, provides redundant measure of ground continuity where jumper is used

APPLICATIONS

- Arrow Hart GFCI receptacles are UL Listed and fully compliant with all of the latest UL943 Class A GFCI and UL498 requirements
- GFCI protection is required wherever receptacles are near wet or damp locations, such as public bathrooms, garages, and food service areas, and all other areas mandated by the NEC



GF15W

Minimal top housing markings for clean aesthetic

Wider TEST/RESET buttons make it easier to test and reset. Device can be reset while a plug is inserted

STANDARD GFCI

2-pole, 3-wire grounding



Rating		NEMA	Color suffix	Catalog no.	Features
W	V/AC				
15	125	5-15R	B, BK, GY, LA, V, W	□GF15__	
15	125	5-15R	BK, W	□GF15__-WP	Includes standard size wallplate
20	125	5-20R	B, BK, GY, LA, RD, V, W	□GF20__*	

Wallplate not included unless specifically stated; *FedSpec certification on 20A only.

Color ordering information:

For ordering devices, include Catalog No. followed by the Color suffix: B (Brown), BK (Black), GY (Gray), LA (Light Almond), RD (Red), V (Ivory), W (White)

AVAILABLE IN THESE COLORS

*For ordering devices, include Cat. no. followed by the color suffix, for example: GF15W



SPECIFICATIONS

Electrical	<p>Dielectric voltage: Withstands 2000V per UL 498</p> <p>Current interrupting: Yes, at full-rated current</p> <p>Temperature rise: Max. 30°C (86°F) after 100 cycles of overload @ 150% of rated current (DC)</p> <p>Trip time: 0.025 seconds (Class A)</p> <p>Frequency: 60 Hz; Voltage: 125V;</p> <p>Amperage: 15A/20A, 20A feed-through</p> <p>Short circuit testing: Meets and exceeds 10 kA</p> <p>Maximum interrupting capacity: 20 Amps</p>
Testing & code compliance	<p>cULus Listed to UL 498 and UL 943, file no. E60120</p> <p>Meets all UL 943 (GFCI), UL 498 (receptacles) and applicable CSA requirements; NOM certified; Federal Specification W-C-596 for 20A models</p>
Environmental	<p>Flammability: Meets UL 94 requirements; V2 rated</p> <p>Temperature rating: -35°C to 66°C (-31°F to 150.8°F)</p>
Mechanical	<p>Terminal accommodation: #14 - 10 AWG</p> <p>Voltage ratings: Permanently marked on device</p>

Compliances, specifications and availability are subject to change without notice.



Scan the QR code for more information on our wallplates



Tamper resistant GFCI receptacle

FEATURES

- Slim design for easy installation, leaving more room for wires in the box
- Child-safety black tamper resistant shutters help prevent improper insertion of foreign objects (keys, hairpins, etc)
- Automatically self-tests periodically to ensure GFCI protection
- GFCIs incorporate lock-out functionality to protect against mis-wired line-load connections and GFCI circuitry damage
- Intuitive LED status indicators for trip and end of life states
- Meets and exceeds 10 kA short circuit testing and Underwriters Laboratories (UL) UL943 safety standards
- Automatic grounding system eliminates need for bonding jumper in grounded metal enclosure, provides redundant measure of ground continuity where jumper is used

APPLICATIONS

- Arrow Hart GFCI receptacles are UL Listed and fully compliant with all of the latest UL943 Class A GFCI and UL498 requirements
- GFCI protection is required wherever receptacles are near wet or damp locations, such as public bathrooms, garages, and food service areas, and all other areas mandated by the NEC
- Complies with NEC Article 406.12 that states that all 15A 125V receptacles installed in dwelling units must be tamper resistant

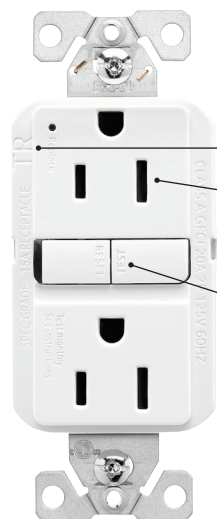

TRGF15W

- TR mark debossed on shoulder
- Tamper resistant shutters are black to disappear from view, adding to the clean, modern look
- Wider TEST/RESET buttons make it easier to test and reset. Device can be reset while a plug is inserted



TAMPER RESISTANT GFCI RECEPTACLE

2-pole, 3-wire grounding



Rating	W	V/AC	NEMA	Color suffix	Catalog no.	Features
15	125	5-15R	B, BK, GY, LA, V, W	□TRGF15__		
15	125	5-15R	W	□TRGF15__-WP	Includes standard size wallplate	
15	125	5-15R	LA, V, W	□TRGF15__-3-L	Pack of three	
15	125	5-15R	W	□TRGF15__50	Pack of 50	
20	125	5-20R	B, BK, GY, LA, RD, V, W	□TRGF20__*		
20	125	5-20R	W	□TRGF20__-3-L*	Pack of three	
20	125	5-20R	W	□TRGF20__50*	Pack of 50	

Wallplate not included unless specifically stated; *FedSpec certification on 20A only.

Color ordering information:

For ordering devices, include Catalog No. followed by the Color suffix: B (Brown), BK (Black), GY (Gray), LA (Light Almond), RD (Red), V (Ivory), W (White)

AVAILABLE IN THESE COLORS

*For ordering devices, include Cat. no. followed by the color suffix, for example: TRGF15W



SPECIFICATIONS

Electrical	<p>Dielectric voltage: Withstands 2000V per UL 498</p> <p>Current interrupting: Yes, at full-rated current</p> <p>Temperature rise: Max. 30°C (86°F) after 100 cycles of overload @ 150% of rated current (DC)</p> <p>Trip time: 0.025 seconds (Class A)</p> <p>Frequency: 60 Hz; Voltage: 125V;</p> <p>Amperage: 15A/20A, 20A feed-through</p> <p>Short circuit testing: Meets and exceeds 10 kA</p> <p>Maximum interrupting capacity: 20 Amps</p>
Testing & code compliance	<p>cULus Listed to UL 498 and UL 943, file no. E60120</p> <p>Meets all UL 943 (GFCI), UL 498 (receptacles) and applicable CSA requirements; NOM certified; Federal Specification W-C-596 for 20A models</p>
Environmental	<p>Flammability: Meets UL 94 requirements; V2 rated</p> <p>Temperature rating: -35°C to 66°C (-31°F to 150.8°F)</p>
Mechanical	<p>Terminal accommodation: #14 - 10 AWG</p> <p>Voltage ratings: Permanently marked on device</p>

Compliances, specifications and availability are subject to change without notice.



Scan the QR code for more information on our wallplates



Tamper and weather resistant GFCI receptacle

FEATURES

- Slim design for easy installation, leaving more room for wires in the box
- Child-safety black tamper resistant shutters help prevent improper insertion of foreign objects (keys, hairpins, etc)
- Nickel-plated stainless steel strap and screws for added corrosion resistance
- Automatically self-tests periodically to ensure GFCI protection
- GFCIs incorporate lock-out functionality to protect against mis-wired line-load connections and GFCI circuitry damage
- Intuitive LED status indicators for trip and end of life states
- Meets and exceeds 10 kA short circuit testing and Underwriters Laboratories (UL) UL943 safety standards
- Automatic grounding system eliminates need for bonding jumper in grounded metal enclosure, provides redundant measure of ground continuity where jumper is used

APPLICATIONS

- Arrow Hart GFCI receptacles are UL Listed and fully compliant with all of the latest UL943 Class A GFCI and UL498 requirements
- GFCI protection is required wherever receptacles are near wet or damp locations, such as public bathrooms, garages, outdoor locations, and food service areas, and all other areas mandated by the NEC
- Complies with NEC Article 406.9 that states that all receptacles installed in wet or damp locations must be weather resistant (Must be installed in weatherproof box)

TAMPER AND WEATHER RESISTANT GFCI RECEPTACLE
2-pole, 3-wire grounding



TWRGF15W

TR and WR markings debossed in top housing

Tamper resistant shutters are black to disappear from view, adding to the clean, modern look

Wider TEST/RESET buttons make it easier to test and reset. Device can be reset while a plug is inserted

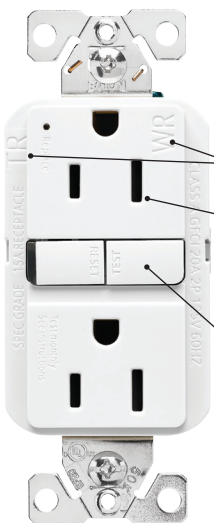

Rating	W	V/AC	NEMA	Color suffix	Catalog no.	Features
15		125	5-15R	B, BK, GY, LA, V, W	□TWRGF15__	
15		125	5-15R	W	□TWRGF15__-50	Pack of 50
20		125	5-20R	B, BK, GY, LA, V, W	□TWRGF20__*	
20		125	5-20R	BK, LA, W	□TWRGF20__-50*	Pack of 50

Wallplate not included unless specifically stated; *FedSpec certification on 20A only.

Color ordering information:

For ordering devices, include Catalog No. followed by the Color suffix: B (Brown)BK (Black), GY (Gray), LA (Light Almond), V (Ivory), W (White)

AVAILABLE IN THESE COLORS

*For ordering devices, include Cat. no. followed by the color suffix, for example: TWRGF15W

B	BK	GY	LA	V	W
Brown	Black	Gray	Light Almond	Ivory	White

SPECIFICATIONS

Electrical	<p>Dielectric voltage: Withstands 2000V per UL 498</p> <p>Current interrupting: Yes, at full-rated current</p> <p>Temperature rise: Max. 30°C (86°F) after 100 cycles of overload @ 150% of rated current (DC)</p> <p>Trip time: 0.025 seconds (Class A)</p> <p>Frequency: 60 Hz; Voltage: 125V;</p> <p>Amperage: 15A/20A, 20A feed-through</p> <p>Short circuit testing: Meets and exceeds 10 kA</p> <p>Maximum interrupting capacity: 20 Amps</p>
Testing & code compliance	<p>cULus Listed to UL 498 and UL 943, file no. E60120</p> <p>Meets all UL 943 (GFCI), UL 498 (receptacles) and applicable CSA requirements; NOM certified; Federal Specification W-C-596 for 20A models</p>
Environmental	<p>Flammability: Meets UL 94 requirements; V2 rated</p> <p>Temperature rating: -35°C to 66°C (-31°F to 150.8°F)</p>
Mechanical	<p>Terminal accommodation: #14 - 10 AWG</p> <p>Voltage ratings: Permanently marked on device</p>

Compliances, specifications and availability are subject to change without notice.



Scan the QR code for more information on our while-in-use covers



Hospital grade GFCI receptacle

FEATURES

- Slim design for easy installation, leaving more room for wires in the box
- Child-safety black tamper resistant shutters help prevent improper insertion of foreign objects (keys, hairpins, etc)
- Automatically self-tests periodically to ensure GFCI protection
- GFCIs incorporate lock-out functionality to protect against mis-wired line-load connections and GFCI circuitry damage
- Intuitive LED status indicators for trip and end of life states
- Meets and exceeds 10 kA short circuit testing and Underwriters Laboratories (UL) UL943 safety standards
- Automatic grounding system eliminates need for bonding jumper in grounded metal enclosure, provides redundant measure of ground continuity where jumper is used
- Hospital grade models UL Listed, fully compliant with all latest UL943 Class A GFCI and UL498 hospital grade requirements

APPLICATIONS

- GFCI protection is required wherever receptacles are near wet or damp locations, such as radiographic rooms, patient bathrooms, hallways & corridors, and all other areas mandated by the NEC

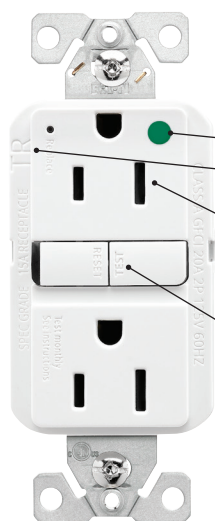

TRGFH15W

- Indicates hospital grade
- TR mark debossed on shoulder
- Tamper resistant shutters are black to disappear from view, adding to the clean, modern look
- Wider TEST/RESET buttons make it easier to test and reset. Device can be reset while a plug is inserted



HOSPITAL GRADE GFCI RECEPTACLES

2-pole, 3-wire grounding



Rating		NEMA	Description	Color suffix	Catalog no.
W	V/AC				
15	125	5-15R	Standard GFCI	RD, V, W	□GFH15__
20	125	5-20R		RD, V, W	□GFH20__*
15	125	5-15R	Tamper resistant GFCI	B, BK, GY, LA, RD, V, W	□TRGFH15__
20	125	5-20R		B, BK, GY, LA, RD, V, W	□TRGFH20__*
15	125	5-15R	Tamper & weather resistant GFCI	W	□TWRGFH15__
20	125	5-20R		W	□TWRGFH20__*

*FedSpec certification on 20A only.

Color ordering information:

For ordering devices, include Catalog No. followed by the Color suffix: B (Brown), BK (Black), GY (Gray), LA (Light Almond), RD (Red), V (Ivory), W (White)

AVAILABLE IN THESE COLORS

*For ordering devices, include Cat. no. followed by the color suffix, for example: TRGFH15W



SPECIFICATIONS

Electrical	<p>Dielectric voltage: Withstands 2000V per UL 498</p> <p>Current interrupting: Yes, at full-rated current</p> <p>Temperature rise: Max. 30°C (86°F) after 100 cycles of overload @ 150% of rated current (DC)</p> <p>Trip time: 0.025 seconds (Class A)</p> <p>Frequency: 60 Hz; Voltage: 125V;</p> <p>Amperage: 15A/20A, 20A feed-through</p> <p>Short circuit testing: Meets and exceeds 10 kA</p> <p>Maximum interrupting capacity: 20 Amps</p>
Testing & code compliance	cULus Listed to UL 498 and UL 943, file no. E60120 Meets all UL 943 (GFCI), UL 498 (receptacles) and applicable CSA requirements; NOM certified; Federal Specification W-C-596 for 20A models
Environmental	<p>Flammability: Meets UL 94 requirements; V2 rated</p> <p>Temperature rating: -35°C to 66°C (-31°F to 150.8°F)</p>
Mechanical	<p>Terminal accommodation: #14 - 10 AWG</p> <p>Voltage ratings: Permanently marked on device</p>

Compliances, specifications and availability are subject to change without notice.



Scan the QR code for more information on our wallplates



Controlled GFCI receptacle

FEATURES

- Slim design for easy installation, leaving more room for wires in the box
- Child-safety black tamper resistant shutters help prevent improper insertion of foreign objects (keys, hairpins, etc)
- Automatically self-tests periodically to ensure GFCI protection
- GFCIs incorporate lock-out functionality to protect against mis-wired line-load connections and GFCI circuitry damage
- Intuitive LED status indicators for trip and end of life states
- Meets and exceeds 10 kA short circuit testing and Underwriters Laboratories (UL) UL943 safety standards
- Automatic grounding system eliminates need for bonding jumper in grounded metal enclosure, provides redundant measure of ground continuity where jumper is used

APPLICATIONS

- Arrow Hart GFCI receptacles are UL Listed and fully compliant with all of the latest UL943 Class A GFCI and UL498 requirements
- GFCI protection is required wherever receptacles are near wet or damp locations, such as public bathrooms, garages, and food service areas, and all other areas mandated by the NEC
- Arrow Hart controlled GFCI receptacles are NEMA approved and compliant with the National Electric Code article 406.3, CA Title 24 standard, and ASHRAE 90.1 Energy Efficiency standard

CONTROLLED GFCI RECEPTACLE

2-pole, 3-wire grounding



Rating		NEMA	Color suffix	Catalog no.
W	V/AC			
15	125	5-15R	BK, GN, GY, LA, V, W	□ TRGFC15__
20	125	5-20R	BK, GN, GY, LA, V, W	□ TRGFC20__*

Wallplate not included unless specifically stated; *FedSpec certification on 20A only.

Color ordering information:

For ordering devices, include Catalog No. followed by the Color suffix: BK (Black), GN (Green), GY (Gray), LA (Light Almond), V (Ivory), W (White)

AVAILABLE IN THESE COLORS

*For ordering devices, include Cat. no. followed by the color suffix, for example: TRGFC15W



SPECIFICATIONS

Electrical	<p>Dielectric voltage: Withstands 2000V per UL 498</p> <p>Current interrupting: Yes, at full-rated current</p> <p>Temperature rise: Max. 30°C (86°F) after 100 cycles of overload @ 150% of rated current (DC)</p> <p>Trip time: 0.025 seconds (Class A)</p> <p>Frequency: 60 Hz; Voltage: 125V;</p> <p>Amperage: 15A/20A, 20A feed-through</p> <p>Short circuit testing: Meets and exceeds 10 kA</p> <p>Maximum interrupting capacity: 20 Amps</p>
Testing & code compliance	<p>cULus Listed to UL 498 and UL 943, file no. E60120</p> <p>Meets all UL 943 (GFCI), UL 498 (receptacles) and applicable CSA requirements; NOM certified; Federal Specification W-C-596 for 20A models</p>
Environmental	<p>Flammability: Meets UL 94 requirements; V2 rated</p> <p>Temperature rating: -35°C to 66°C (-31°F to 150.8°F)</p>
Mechanical	<p>Terminal accommodation: #14 - 10 AWG</p> <p>Voltage ratings: Permanently marked on device</p>

Compliances, specifications and availability are subject to change without notice.

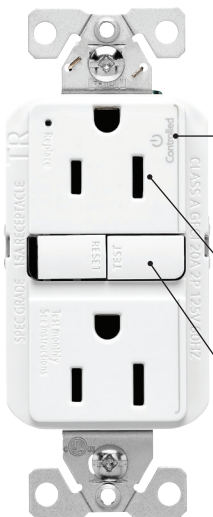

TRGFC15W

NEMA-approved controlled symbol and "controlled" pad printed on the face of the receptacle provides easy recognition of controlled outlet

Tamper resistant shutters are black to disappear from view, adding to the clean, modern look

Wider TEST/RESET buttons make it easier to test and reset. Device can be reset while a plug is inserted



Scan the QR code for more information on our controlled receptacles



Tamper resistant AFCI receptacle

FEATURES

- Slimmer design for easy installation, leaving more room for wires in the box
- Child-safety black tamper resistant shutters help prevent improper insertion of foreign objects
- AFCI Receptacles incorporate lock-out functionality to protect against mis-wired line-load connections and AFCI circuitry damage
- Wider button wells for easy TEST and RESET
- Intuitive LED status indicators for trip and end of life states
- Clean, modern industrial design with reduced top housing markings and neutral text direction on buttons
- Meets and exceeds 10kA short circuit testing and Underwriters Laboratories UL 1699A and UL 498 Safety standards
- Automatic grounding system eliminates need for bonding jumper in grounded metal enclosure, provides redundant measure of ground continuity where jumper is used
- External backwire clamps provide visual confirmation of secure termination
- Line side terminals are backed out and staked for fast installation

APPLICATIONS

- AFCI receptacles provide protection against unseen arc faults that can result in electrical fires
- National Electric Code (NEC) mandates AFCI protection in dwelling units areas such as sunrooms, parlors, libraries, dens, rec rooms and closets.
- Other Occupancy types where AFCIs are required are dormitories, guest rooms and guest suites of hotels and motels, areas used exclusively as patient sleeping rooms in nursing homes and limited care facilities and areas designed for use exclusively as sleeping quarters in fire stations, police stations, ambulance stations, rescue stations, ranger stations, and similar locations.

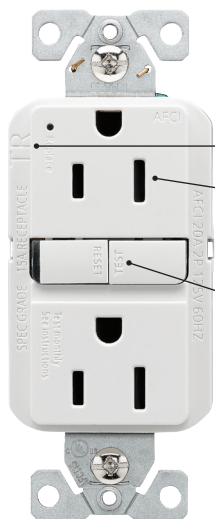

TRAF15W

- TR mark debossed on shoulder
- Tamper resistant shutters are black to disappear from view, adding to the clean, modern look
- Wider TEST/RESET buttons make it easier to test and reset. Device can be reset while a plug is inserted



TAMPER RESISTANT AFCI RECEPTACLE

2-pole, 3-wire grounding



Rating		NEMA	Color suffix	Catalog no.
W	V/AC			
15	125	5-15R	B, BK, GY, LA, V, W	□TRAF15_
20	125	5-20R	B, BK, GY, LA, V, W	□TRAF20_*

*FedSpec certification on 20A only.

Color ordering information:

For ordering devices, include Catalog No. followed by the Color suffix: B (Brown), BK (Black), GY (Gray), LA (Light Almond), V (Ivory), W (White)

AVAILABLE IN THESE COLORS

*For ordering devices, include Cat. no. followed by the color suffix, for example: TRAF15_W



SPECIFICATIONS

Electrical	<p>Dielectric voltage: Withstands 2000V per UL 498</p> <p>Current interrupting: Yes, at full-rated current</p> <p>Temperature rise: Max. 30°C (86°F) after 100 cycles of overload @ 150% of rated current (DC)</p> <p>Trip time: Less than 110ms @ Series Arcs above 30A</p> <p>Frequency: 60 Hz; Voltage: 125V;</p> <p>Amperage: 15A/20A, 20A feed-through</p> <p>Short circuit testing: Meets and exceeds 10 kA</p> <p>Maximum interrupting capacity: 20 Amps</p>
Testing & code compliance	<p>cULus Listed to UL1699/A and UL498, File no. E341748</p> <p>Meets all UL UL1699/A (AFCI) and UL498 (Receptacles) requirements and cULus to CEC part II and CSA C22.2 No. 0 and C22.2, No.42. Federal Specification W-C-596H for 20A models</p>
Environmental	<p>Flammability: Meets UL 94 requirements; V2 rated</p> <p>Temperature rating: -35°C to 66°C (-31°F to 150.8°F)</p> <p>Operating Areas: Indoor use Relative Humidity: 98% RH; non-condensing</p>
Mechanical	<p>Terminal accommodation: #14 - 10 AWG</p> <p>Voltage ratings: Permanently marked on device</p>

Compliances, specifications and availability are subject to change without notice.



Scan the QR code for more information on our AFCI receptacles



Tamper resistant AF/GF receptacle

FEATURES

- Slimmer design for easy installation, leaving more room for wires in the box
- Automatically self-tests periodically to ensure GFCI protection
- Child-safety black tamper resistant shutters help prevent improper insertion of foreign objects
- AF/GF Receptacles incorporate lock-out functionality to protect against mis-wired line-load connections and AF/GF circuitry damage
- Wider button wells for easy TEST and RESET
- Intuitive LED status indicators for trip and end of life states
- Clean, modern industrial design with reduced top housing markings and neutral text direction on buttons
- Meets and exceeds 10 kA short circuit testing and Underwriters Laboratories (UL) UL943, UL 1699A and UL 498 Safety standards
- Automatic grounding system eliminates need for bonding jumper in grounded metal enclosure, provides redundant measure of ground continuity where jumper is used
- External backwire clamps provide visual confirmation of secure termination
- Line side terminals are backed out and staked for fast installation

APPLICATIONS

- AF/GF receptacles provide protection against both Arc Faults (series and downstream parallel) and Ground Faults.
- National Electric Code (NEC) mandates AF/GF protection in dwelling units areas such as Kitchens, Bedrooms, hallways, laundry rooms and basements

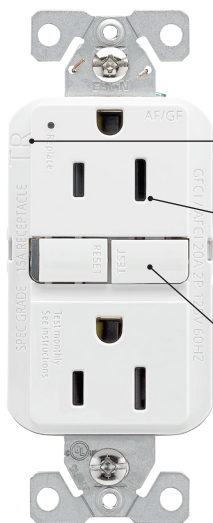

TRAG15W

- TR mark debossed on shoulder
- Tamper resistant shutters are black to disappear from view, adding to the clean, modern look
- Wider TEST/RESET buttons make it easier to test and reset. Device can be reset while a plug is inserted



TAMPER RESISTANT AF/GF RECEPTACLES

2-pole, 3-wire grounding



Rating		NEMA	Color suffix	Catalog no.
W	V/AC			
15	125	5-15R	B, BK, GY, LA, V, W	□TRAG15__
20	125	5-20R	B, BK, GY, LA, V, W	□TRAG20__*

Color ordering information:

For ordering devices, include Catalog No. followed by the Color suffix: BK (Black), GN (Green), GY (Gray), LA (Light Almond), V (Ivory), W (White)

AVAILABLE IN THESE COLORS

*For ordering devices, include Cat. no. followed by the color suffix, for example: GF15_W



SPECIFICATIONS

Electrical	<p>Dielectric voltage: Withstands 2000V per UL 498</p> <p>Current interrupting: Yes, at full-rated current</p> <p>Temperature rise: Max. 30°C (86°F) after 100 cycles of overload @ 150% of rated current (DC)</p> <p>Trip time: 0.025 seconds (Class A), Less than 110 mS @ Series Arcs above 30A</p> <p>Frequency: 60 Hz; Voltage: 125V;</p> <p>Amperage: 15A/20A, 20A feed-through</p> <p>Short circuit testing: Meets and exceeds 10 kA</p> <p>Maximum interrupting capacity: 20 Amps</p>
Testing & code compliance	<p>cULus Listed to UL943, UL1699/A and UL498, File no. E482200. Meets all UL 943 (GFCI) UL1699/A (AFCI) and UL498 (Receptacles) requirements and cULus to CEC part II and CSA C22.2 No. 0 and C22.2, No.42. Federal Specification W-C-596H for 20A models</p>
Environmental	<p>Flammability: Meets UL 94 requirements; V2 rated</p> <p>Temperature rating: -35°C to 66°C (-31°F to 150.8°F)</p>

Compliances, specifications and availability are subject to change without notice.



Scan the QR code for more information on our AF/GF receptacles



GFCI Blank face device

FEATURES

- Slimmer design for easy installation, leaving more room for wires in the box
- Automatically self-tests periodically to ensure GFCI protection
- Wider button wells for easy TEST and RESET
- Trip indicator makes it easy to diagnose ground faults
- Line-load miswiring protection: GFCIs will not provide power downstream when wired incorrectly
- Clean, modern industrial design with reduced top housing markings and neutral text direction on buttons
- Meets and exceeds 10 kA short circuit testing and Underwriters Laboratories (UL) UL943 safety standards
- Automatic grounding system eliminates need for bonding jumper in grounded metal enclosure, provides redundant measure of ground continuity where jumper is used
- External backwire clamps provide visual confirmation of secure termination
- Line side terminals are backed out and staked for fast installation

APPLICATIONS

- Arrow Hart GFCI receptacles are UL Listed and fully compliant with all of the latest UL943 Class A GFCI and UL498 requirements
- GFCI protection is required wherever receptacles are near wet or damp locations, such as public bathrooms, garages, and food service areas, and all other areas mandated by the NEC



GFD20W

Wider TEST/RESET buttons make it easier to test and reset.

STANDARD SLIM GFCI BLANK FACE

2-pole, 3-wire grounding



Rating		Color suffix	Catalog no.
W	V/AC		
20	125	B, BK, LA, V, W	□GFD20__*

Color ordering information:

For ordering devices, include Catalog No. followed by the Color suffix: B (Brown), BK (Black), LA (Light Almond), V (Ivory), W (White)

AVAILABLE IN THESE COLORS

*For ordering devices, include Cat. no. followed by the color suffix, for example: GF15_W



SPECIFICATIONS

Electrical	<p>Dielectric voltage: Withstands 2000V per UL 498</p> <p>Current interrupting: Yes, at full-rated current</p> <p>Temperature rise: Max. 30°C (86°F) after 100 cycles of overload @ 150% of rated current (DC)</p> <p>Trip time: 0.025 seconds (Class A)</p> <p>Frequency: 60 Hz; Voltage: 125V;</p> <p>Amperage: 20A, 20A feed-through</p> <p>Short circuit testing: Meets and exceeds 10 kA</p> <p>Maximum interrupting capacity: 20 Amps</p>
Testing & code compliance	<p>cULus Listed to UL 498 and UL 943, file no. E60120</p> <p>Meets all UL 943 (GFCI), UL 498 (receptacles), UL508 (motor control) and applicable CSA requirements; NOM certified; Federal Specification W-C-596 for 20A models</p>
Environmental	<p>Flammability: Meets UL 94 requirements; V2 rated</p> <p>Temperature rating: -35°C to 66°C (-31°F to 150.8°F)</p>
Mechanical	<p>Terminal accommodation: #14 - 10 AWG</p> <p>Voltage ratings: Permanently marked on device</p> <p>Horsepower ratings: Rated for motor loads per UL508: 20A: @ 125V/AC = 1.5 HP, max. amps 20 full load amps</p>

Compliances, specifications and availability are subject to change without notice.



Scan the QR code for more information on our blank face devices

We make what matters work.*

* At Eaton, we believe that power is a fundamental part of just about everything people do. Technology, transportation, energy and infrastructure-these are things the world relies on every day. That's why Eaton is dedicated to helping our customers find new ways to manage electrical, hydraulic and mechanical power more efficiently, safely and sustainably. To improve people's lives, the communities where we live and work, and the planet our future generations depend upon. Because that's what really matters. And we're here to make sure it works.

See more at Eaton.com/whatmatters



Scan QR code for more information on AFCI, AF/GF, & GFCI devices

Electrical Sector
1123 Hwy 74 S
Peachtree City, GA 30269
United States
Eaton.com
Eaton.com/wiringdevices

Eaton
1000 Eaton Boulevard
Cleveland, OH 44122
United States
Eaton.com

© 2024 Eaton
All Rights Reserved
Printed in USA
Publication No. BR610090EN
October 2024

Electrical Sector
Canada Operations
5925 McLaughlin Road
Mississauga, Ontario, L5R 1B8
Canada
EatonCanada.ca
Eaton.com/wiringdevices

Eaton is a registered trademark.
All other trademarks are property of their respective owners.

Electrical Sector
Mexico Operations
Carr. Tlalnepantla -
Cuautitlan Km 17.8 s/n
Col. Villa Jardin esq.
Cerrada 8 de Mayo
Cuautitlan, Mexico CP 54800
Mexico
Eaton.mx
Eaton.com/wiringdevices

Follow us on social media to get the latest product and support information.

