



Powering Business Worldwide

ENGLISH

RF9643-N - Z-Wave Plus™ Wireless Universal Dimmer - For dimmable LED/CFL/ INC/ MLV/ ELV/HAL/FLR
RF9642-Z - Z-Wave Plus™ Accessory Dimmer - For multi-locations (when used with RF9643-N)

- WARNINGS AND CAUTIONS:
Turn circuit breaker to OFF position or remove fuse(s) and test that power is OFF before installation process.
Never wire any electrical device with power turned ON.
If you are not sure about any part of these instructions, please contact a licensed electrician.

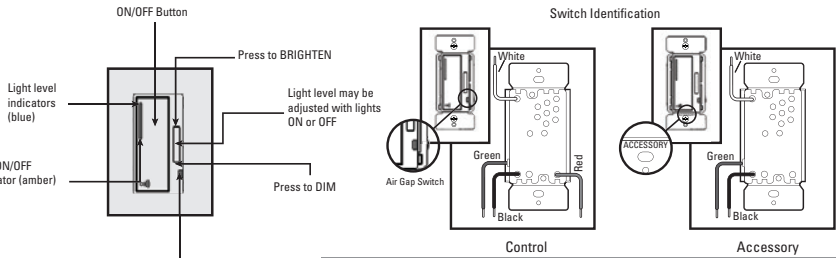

Single Location Control Installation (requires one Dimmer)

- NOTES:
The Z-Wave Plus Wireless Universal Dimmer is wired directly to the light fixture.
For Multi-location applications refer to the wiring diagrams.
The Z-Wave Plus Accessory Dimmer communicates via RF signals to control the light from more than one location.

Two Location Control Installation (One Dimmer and One Accessory Dimmer)

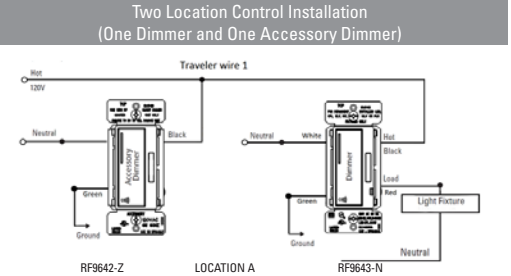

Note : Please use a compatible Z-Wave controller which supports association

Two Location Control Installation (One Dimmer and 3-way switch using Hot wire)

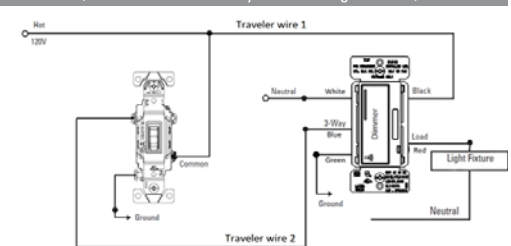

Two Location Control Installation (One Dimmer and 3-way switch using Neutral wire)

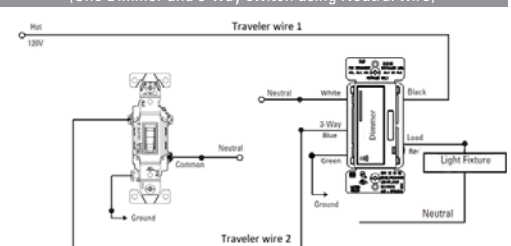

- Adding Z-Wave Plus Wireless Universal Dimmer to a Z-Wave Network:
1. To include this device in a Z-Wave network, select the command on your Z-Wave controller for inclusion (Install, Add Device, Add Node, Include Device, etc.).

- Removing Z-Wave Plus Wireless Universal Dimmer from a Z-Wave Network:
1. To exclude this device from a Z-Wave network, select the setting on your Z-Wave controller for exclusion (Uninstall, Remove Device, Remove Node, Exclude Device, etc.).

- Operating Instructions:
Press ON/OFF button once to turn lights ON at previously selected level.
Press ON/OFF button again to turn lights OFF.
When lights are OFF, press and hold ON/OFF button for 2 seconds for full brightness of overhead light.

- Dimming Level Adjustment (RF9643-N only):
For maximum compatibility with different load types, RF9643-N allows the user to set the minimum dim level or low end trim.

- Changing LED Indicator brightness: (RF9643-N & RF9642-Z)
This feature allows the change of the brightness of the blue LED indicators on the device. There are 5 levels (including fully OFF and full brightness) to change the LED indicator brightness level either while the device is ON or OFF state.

- Before leaving the network the dimmer will send a notification to the controller indicating its departure from the Z-Wave network.
Turn the device ON.
Press and hold ON/OFF button for 20 second till the LED flashes for the fifth time.

Configuration parameters: RF9643-N

Table with 3 columns: Parameter, Description, Value. Includes parameters like Delayed OFF Time, Panic ON/Off Time, Power Up State, etc.

Troubleshooting Guide

Table with 3 columns: Symptoms, Possible Cause, Solution. Includes symptoms like Device doesn't function, Erratic operation, etc.

FCC STATEMENT
This device complies with Part 15 of the FCC Rules. Operation is subject to the following two conditions:
1. This device may not cause harmful interference, and
2. This device must accept any interference received, including interference that may cause undesired operation.

EATON WIRING DEVICES LIMITED 2 YEAR WARRANTY
Eaton Wiring Devices warrants its Dimmer to be free of defects in materials and workmanship in normal use and service for a period of two years from date of original purchase.

Wattage Ratings

Table with 4 columns: Load Type, Single Gang, 2-Gang, 3-Gang. Shows wattage ratings for RF9643-N.

RF9642-Z

Table with 3 columns: Parameter, Description, Value. Includes parameters like Delayed OFF Time, Panic ON/Off Time, etc.

Association groups supported:

Table with 2 columns: Association Group, Limit. Lists supported groups like Group 1 (lifeline), Group 2 (ON/OFF), etc.



Powering Business Worldwide

FRANÇAIS

RF9643-N – Gradateur universel sans fil Z-Wave Plus – Pour DEL/FLC/INC/MBT/ÉBT/HAL/FLUO à intensité réglable
RF9642-Z – Gradateur asservi Z-Wave Plus – À plusieurs emplacements (lorsqu'utilisé avec des RF9643-N)

- AVERTISSEMENTS ET MISES EN GARDE:
Ne jamais brancher un appareil électrique si la tension n'est pas coupée.
Si une partie des présentes instructions n'est pas claire, consulter un électricien agréé.

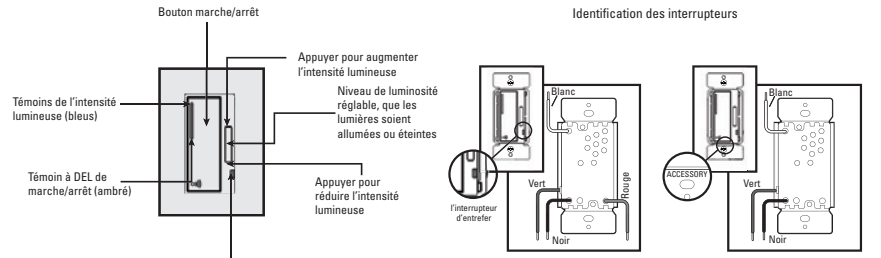

Installation de la commande à un emplacement unique (un gradateur principal requis)

- REMARQUES:
Le gradateur universel sans fil Z-Wave Plus se connecte directement aux luminaires.
Dans une installation à 3 ou 4 voies, utiliser le gradateur asservi Z-Wave (RF9642-Z) avec un gradateur universel Z-Wave.

Installation de la commande à deux emplacements (un gradateur principal et un gradateur asservi requis)

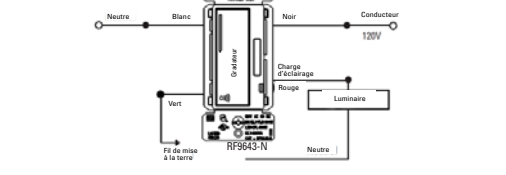

- INSTRUCTIONS RELATIVES AU RÉSEAU DE L'APPAREIL Z-WAVE:
Ce produit peut être ajouté à un réseau Z-Wave nouveau ou existant.
Ce produit peut faire partie du même réseau que d'autres produits de la gamme Z-Wave.

Installation de la commande à deux emplacements (un gradateur et un interrupteur à 3 voies utilisant un fil sous tension)

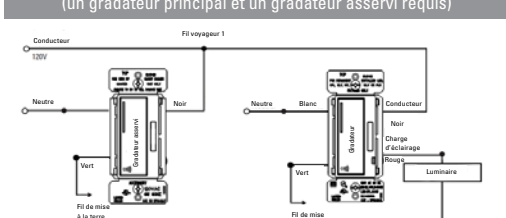

- Instructions d'installation:
Appuyer sur le bouton marche/arrêt pour allumer les lumières à l'intensité précédemment sélectionnée.
Appuyer sur le bouton marche/arrêt et le tenir enfoncé pendant 5 secondes jusqu'à ce que les témoins à DEL bleus se mettent à clignoter.

Installation de la commande à deux emplacements (un gradateur et un interrupteur à 3 voies utilisant un fil neutre tension)

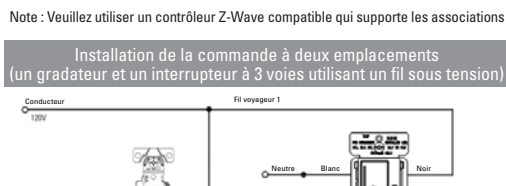

- Ajustement du niveau de gradation (RF9643-N seulement):
Pour assurer une compatibilité optimale avec différentes charges, le RF9643-N offre à l'utilisateur la possibilité de régler le niveau de gradation minimal ou l'ajustement à seuil faible.
Fonction de mise en marche rapide (RF9643-N seulement):
Grâce à cette fonction, les lumières à DEL et les fluo-compactes peuvent s'allumer lorsque le niveau préréglé du gradateur est bas.

